

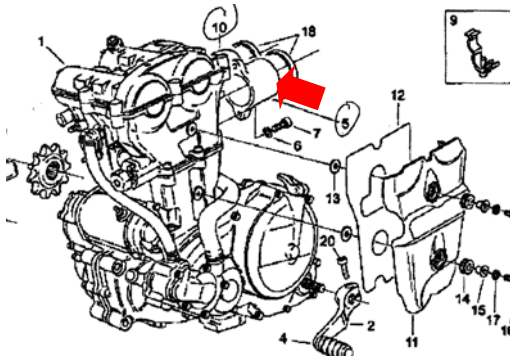

Scottoil: Aprilia Pegaso Fi (2000-) Installation Guide for Aprilia Pegaso Fi (2000-)



Locate the vacuum – Remove the inlet manifold and drill a 4mm hole in one side. Tap the hole using an M5 tap and fit the M5 Brass Spigot from the Scottoil kit, using washers and an RTV, silicon type sealant, to ensure an airtight seal.

Re-install the manifold and then press the Damper Elbow, part number 4, onto the spigot.

Caution: Remove any drilling Swarf / loose material from the manifold before re-installation.



The RMV can be positioned under the seat, as shown left.

The more vertical the RMV the better and remember to avoid engine and exhaust components.

For further information see our easy step installation guide - '**RMV Positions, General**'.



Note: Picture shows a similar Swingarm

The Dispenser Assembly, shown left, is routed along the underside of the Swingarm using Dispenser Mounting Sleeves, Cable Ties & Glue. **Note:** an epoxy resin (eg. Araldite) is req'd to bond the sleeves to the Swingarm.

For further information see our easy step installation guide - '**Dispenser Assemblies, General**'.

The nib should feed the sprocket between the 6 & 7 o'clock positions, with the cut face facing outwards, as shown bottom left.



Note: This is a generic image

Once fitted, fill and prime the system and set the adjuster knob to 'prime'.

Start the engine and turn the adjuster knob until a flow of between 1 and 2 drops per minute is achieved.

Check the condition of your chain after a ride, and then adjust as required.

If you have any further comments or queries, and are unable to resolve them using our website, please do not hesitate to call technical on 0141 955 1100 or email technical@scottoiler.com for assistance. Thank you.

Scottoil Ltd. 2 Riverside, Milngavie, Glasgow, G62 6PL Tel. 0141 955 1100 Fax. 0141 956 5896 www.scottoiler.com

