



Scottoil: Honda VT600

Installation Guide for Honda VT600



Locate the vacuum – In front of the carburetor there is a vacuum pipe which goes to a T-Piece branching to the Carb itself and the PAIR valve, as shown below left.

Cut into any of these pipes and insert the T-Piece from the Scottoil kit. Then press the Damper Elbow, part number 4, onto the third leg of the tee.

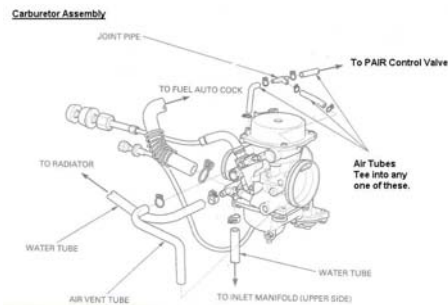

The RMV can be mounted under the seat or behind the number plate. The more vertical the RMV the better and remember to avoid exhaust and engine components.

For further information, see our easy step installation guide – '**RMV Positions, General**'.



The Dispenser Assembly, shown left, is routed along the underside of the Swingarm using Dispenser Mounting Sleeves, Cable Ties & Glue. **Note:** an epoxy resin (eg. Araldite) is req'd to bond the sleeves to the Swingarm.

For further information see our easy step installation guide - '**Dispenser Assemblies, General**'.

The nib should feed the sprocket between the 6 & 7 o'clock positions, with the cut face facing outwards, as shown bottom left.



Once fitted, fill and prime the system and set the adjuster knob to 'prime'.

Start the engine and turn the adjuster knob until a flow of between 1 and 2 drops per minute is achieved.

Check the condition of your chain after a ride, and then adjust as required.

Note: This is a generic image

If you have any further comments or queries, and are unable to resolve them using our website, please do not hesitate to call technical on 0141 955 1100 or email technical@scottoiler.com for assistance. Thank you.

Scottoil Ltd. 2 Riverside, Milngavie, Glasgow, G62 6PL Tel. 0141 955 1100 Fax. 0141 956 5896 www.scottoiler.com

