

Scottoiler®



eSystem Quick Setup Guide

Driving Screen

The driving screen is the default screen that provides you with the majority of information you require during general use of the eSystem. The following information is displayed;



- Flowrate:** The flowrate represents the time in seconds between drops of oil. The recommendation is for 50 - 60 seconds but this can be set from 10 - 90 seconds per drop or OFF. Pressing 'set' will cycle through the settings. The drop LED will flash when a drop is dispensed.
- Temperature:** The ambient temperature is displayed in degrees Celcius.
- Oil Level:** Shows the current level of oil present in the reservoir.
- Acceleration:** Your acceleration is used to sense the motion of the bike and turn the oil flow on and off. In addition, the display also gives an instantaneous representation of your forward acceleration in g-force.

Parts List

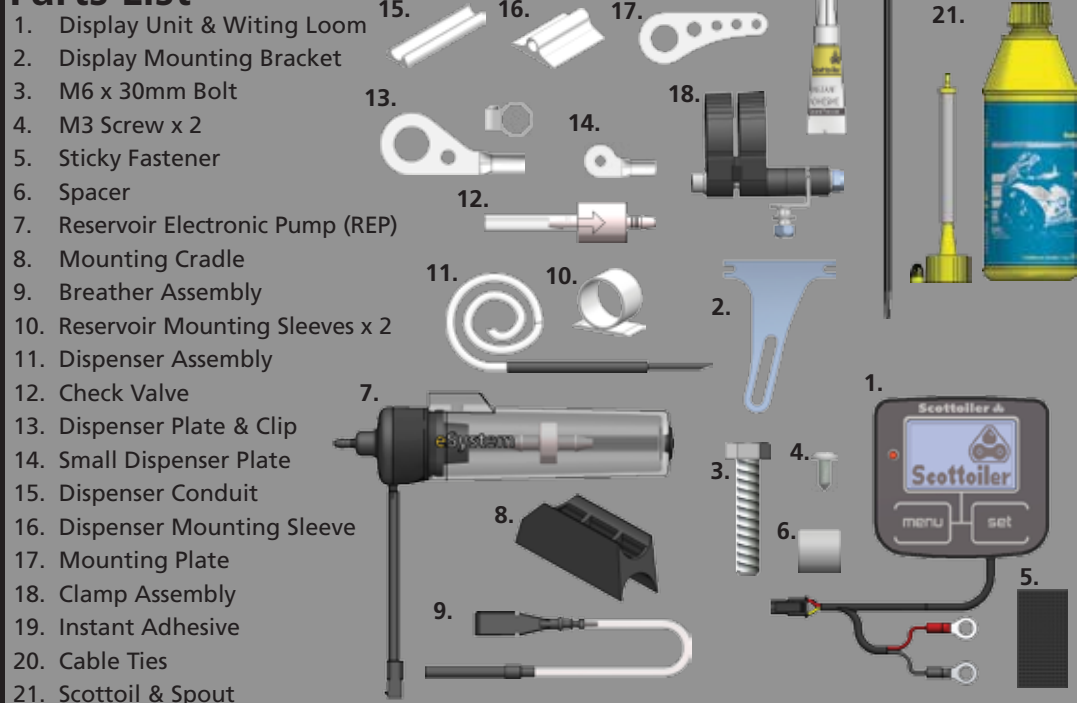

Setup Instructions

1. Start your bike's engine. The eSystem will automatically turn on and you'll see the introduction screen.



2. After a few seconds you will be presented with the default 'Driving Screen'. This displays the information that you'll require during general usage of the eSystem.

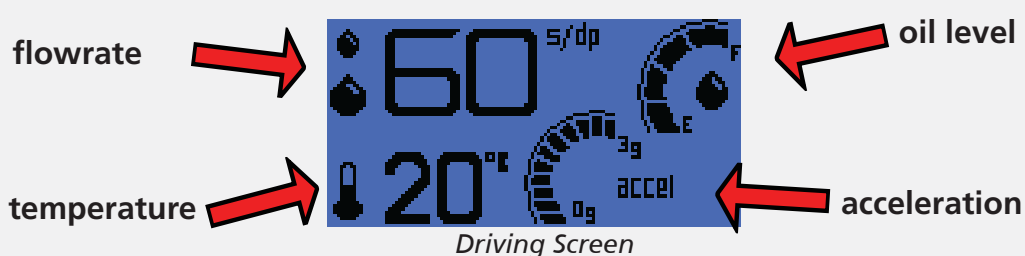

3. Press 'menu' once to take you to the Prime Menu screen. Press 'set' once to initiate a 10 second prime cycle. Repeat this step until oil starts dripping from your dispenser nozzle.



4. Top up your reservoir with oil

5. Press 'menu' until you reach the Reservoir Menu screen.



6. Hold 'set' until the reservoir bar fills to 100%. This step should be carried out every time you refill your reservoir.

Note: It is possible to set the reservoir to 25%, 50% or 75% of capacity.



7. Press 'menu' until you reach the 'Driving Screen'.

8. Press 'set' repeatedly until the flow rate is at your desired level.

Note: We recommend starting with a flow rate of 50 - 60 s/dp.



Priming Menu

The prime menu allows you to start the oiler running at a high rate to prime the system's oil delivery tubing. When 'set' is pressed the system will prime for a 10 second cycle. This is to protect the pump from excessive continuous dry use.



The eSystem prime function should be repeatedly run until oil starts to drip from the dispenser nozzle and there are no air bubbles in the tubing.



The prime setting is usually only required on first installation but can also be used to remove air bubbles from your oil line and to test the oiler when stationary.

Oil Level Menu

The oil level menu allows you to tell the eSystem when the reservoir has been refilled and with how much oil. By holding the 'set' button the reservoir bar will fill from 0% to 100% in 25% increments.



The eSystem knows exactly the quantity of each oil drop and the volume of the reservoir. It can therefore keep track of your oil level and inform you when it is running low.



Everytime the eSystem reservoir is refilled or topped up the reservoir menu should be updated to show this change.

Additional Reservoir Menu

Scottoiler offer a range of additional reservoirs that are compatible with the eSystem. These reservoirs increase the oil capacity of the system. Therefore, in order to keep the oil level indicator accurate it is possible to 'add-on' one of these reservoirs.



The standard screen will show 'None' meaning there are no additional reservoirs in use. By pressing the 'set' button this option will cycle through the available additional reservoirs and let the eSystem know its new capacity.

Note: When an additional reservoir is in place the oil level gauge will show the overall capacity of the system. Therefore, when both the eSystem reservoir and the additional reservoir are full the oil level should be set to 100%.

